



inserts:		page
CDD	42 poles + ⊕	55
CQE	18 poles + ⊕	75
CN	10 poles + ⊕	81
CCE	10 poles + ⊕	88
CNE, CSE.....	10 poles + ⊕	89
CSS	10 poles + ⊕	100
CTE, CTSE.....	10 poles + ⊕	107
CMSE	3+2 (aux) poles + ⊕	114
CMCE	3+2 (aux) poles + ⊕	114
CX	8/24 poles + ⊕	129
MIXO	3 modules	137÷151

insert centre distance:
57 x 27 mm

bulkhead mounting housings
with 2 levers or 4 pegs



bulkhead mounting housings
with single lever



description	part No.	part No.
with lever/s	CHI 10	CHI 10 L
with pegs ¹⁾	CHI 10 C	
with pegs and aluminium cover ¹⁾	CHI 10 CS	
with pegs and plastic cover ¹⁾	CHI 10 CP	
with lever and cover		CHI 10 LS

¹⁾ May be combined with hoods:
- CHO/CAO 10 X and CHV/CAV 10 X
- MHO/MAO 10 X and MHV/MAV 10 X

N.B.: the enclosures ensure IP66 protection (or IP65 cover versions) rating when mated and locked with the closing levers.
The cover (CS, CP) only ensures mechanical protection, but does not ensure IP65 protection rating.

panel cut-out for bulkhead mounting housings in mm

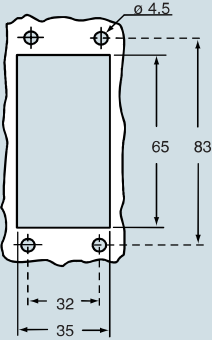

dimensions in mm

CHI

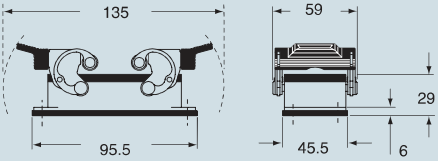

CHI C

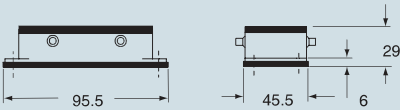

CHI CS/CP

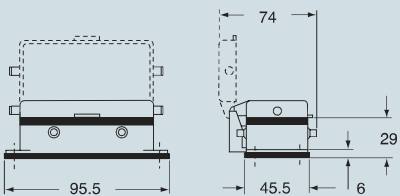

dimensions in mm

CHI L

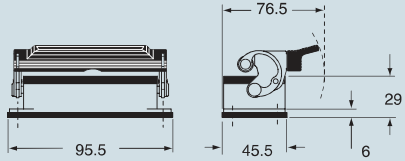

CHI LS

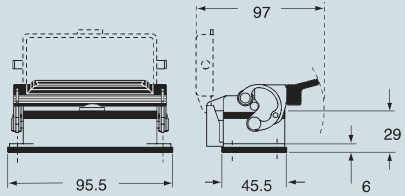

CAUS® Type
4/4X/12

(excluding enclosures with plastic cover)

dimensions indicated are not binding
and may be changed without notice

inserts:		page
CDD	42 poles + ⊕	55
CQE	18 poles + ⊕	75
CN	10 poles + ⊕	81
CCE	10 poles + ⊕	88
CNE, CSE	10 poles + ⊕	89
CSS	10 poles + ⊕	100
CMSE	3+2 (aux) poles + ⊕	114
CMCE	3+2 (aux) poles + ⊕	114
CX	8/24 poles + ⊕	129
MIXO	3 modules	137÷151

insert centre distance:
57 x 27 mm

surface mounting housings with 2 levers or 4 pegs



surface mounting housings with single lever

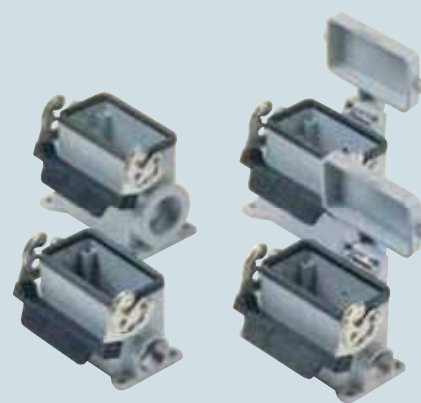

description	part No.	entry Pg	part No.	entry M	part No.	entry Pg	part No.	entry M
with levers	CHP 10	16	MHP 10.20	20	CHP 10 L	16	MHP 10 L20	20
with levers	CHP 10.2	16 x 2	MHP 10.220	20 x 2	CHP 10 L2	16 x 2	MHP 10 L220	20 x 2
with levers, high construction	CAP 10.21	21	MAP 10.32	32	CAP 10 L	21	MAP 10 L32	32
with levers, high construction	CAP 10.221	21 x 2	MAP 10.232	32 x 2	CAP 10 L2	21 x 2	MAP 10 L232	32 x 2
with levers, high construction	CAP 10.29	29	MAP 10.40	40	CAP 10 L29	29	MAP 10 L40	40
with levers, high construction	CAP 10.229	29 x 2	MAP 10.240	40 x 2	CAP 10 L229	29 x 2	MAP 10 L240	40 x 2
with pegs and aluminium cover ¹⁾	CHP 10 CS	16	MHP 10 CS20	20				
with pegs and aluminium cover ¹⁾	CHP 10 CS2	16 x 2	MHP 10 CS220	20 x 2				
with pegs and aluminium cover, high construction ¹⁾	CAP 10 CS	21	MAP 10 CS32	32				
with pegs and aluminium cover, high construction ¹⁾	CAP 10 CS2	21 x 2	MAP 10 CS232	32 x 2				
with pegs and aluminium cover, high construction ¹⁾	CAP 10 CS29	29	MAP 10 CS40	40				
with pegs and aluminium cover, high construction ¹⁾	CAP 10 CS229	29 x 2	MAP 10 CS240	40 x 2				
with pegs and plastic cover ¹⁾	CHP 10 CP	16	MHP 10 CP20	20				
with pegs and plastic cover ¹⁾	CHP 10 CP2	16 x 2	MHP 10 CP220	20 x 2				
with pegs and plastic cover, high construction ¹⁾	CAP 10 CP	21	MAP 10 CP32	32				
with pegs and plastic cover, high construction ¹⁾	CAP 10 CP2	21 x 2	MAP 10 CP232	32 x 2				
with pegs and plastic cover, high construction ¹⁾	CAP 10 CP29	29	MAP 10 CP40	40				
with pegs and plastic cover, high construction ¹⁾	CAP 10 CP229	29 x 2	MAP 10 CP240	40 x 2				
with lever and cover					CHP 10 LS	16	MHP 10 LS20	20
with lever and cover					CHP 10 LS2	16 x 2	MHP 10 LS220	20 x 2
with lever and cover, high construction					CAP 10 LS	21	MAP 10 LS32	32
with lever and cover, high construction					CAP 10 LS2	21 x 2	MAP 10 LS232	32 x 2
with lever and cover, high construction					CAP 10 LS29	29	MAP 10 LS40	40
with lever and cover, high construction					CAP 10 LS229	29 x 2	MAP 10 LS240	40 x 2

¹⁾ May be combined with hoods:
- CHO/CAO 10 X and CHV/CAV 10 X
- MHO/MAO 10 X and MHV/MAV 10 X

N.B.: the enclosures ensure IP66 protection (or IP65 cover versions) rating when mated and locked with the closing levers.

The cover (CS, CP) only ensures mechanical protection, but does not ensure IP65 protection rating.

dimensions in mm CHP - CAP and MHP - MAP

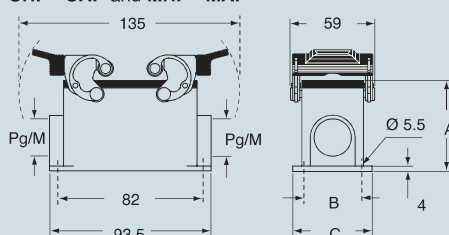

CHP CS/CP - CAP CS/CP and MHP CS/CP - MAP CS/CP

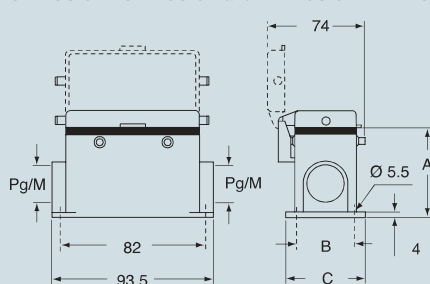

type	A	B	C
CHP / MHP	57	40	52
CAP / MAP	74	45	57
CHP CS / MHP CS	57	40	52
CAP CS / MAP CS	74	45	57
CHP CP / MHP CP	57	40	52
CAP CP / MAP CP	74	45	57

dimensions in mm CHP L - CAP L and MHP L - MAP L

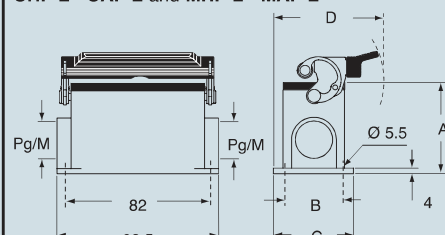

CHP LS - CAP LS and MHP LS - MAP LS

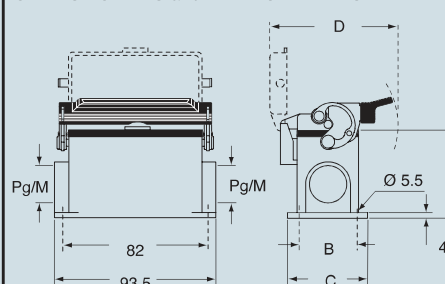

type	A	B	C	D
CHP L / MHP L	57	40	52	79.5
CAP L / MAP L	74	45	57	82
CHP LS / MHP LS	57	40	52	97
CAP LS / MAP LS	74	45	57	97

CAV[®] Type
4/4X/12

(excluding enclosures with plastic cover)

dimensions indicated are not binding
and may be changed without notice

inserts:		page
CDD	42 poles + ⊕	55
CQE	18 poles + ⊕	75
CN	10 poles + ⊕	81
CCE	10 poles + ⊕	88
CNE, CSE	10 poles + ⊕	89
CSS	10 poles + ⊕	100
CMSE	3+2 (aux) poles + ⊕	114
CMCE	3+2 (aux) poles + ⊕	114
CX	8/24 poles + ⊕	129
MIXO	3 modules	137÷151

insert centre distance:
57 x 27 mm

hoods
with 4 pegshoods
with 2 pegs

description	part No.	entry Pg	part No.	entry M	part No.	entry Pg	part No.	entry M
with pegs, side entry	CHO 10	16	MHO 10.20	20	CHO 10 L	16	MHO 10 L20	20
with pegs, side entry			MHO 10.25	25			MHO 10 L25	25
with pegs, side entry, high construction	CAO 10.21	21	MAO 10.32	32	CAO 10 L21	21	MAO 10 L32	32
with pegs, side entry, high construction	CAO 10.29	29	MAO 10.40	40	CAO 10 L29	29	MAO 10 L40	40
with pegs, top entry	CHV 10	16	MHV 10.20 **	20	CHV 10 L	16	MHV 10 L20 **	20
with pegs, top entry			MHV 10.25	25			MHV 10 L25	25
with pegs, top entry, high construction	CAV 10.21	21	MAV 10.32	32	CAV 10 L21	21	MAV 10 L32	32
with pegs, top entry, high construction	CAV 10.29	29	MAV 10.40	40	CAV 10 L29	29	MAV 10 L40	40
with pegs, frontal entry, high construction	CAF 10	16	MAF 10.20	20				
with pegs, frontal entry, high constr., without adaptor *	CFF 10	16	MFF 10.20	20				

* enclosure without adaptor, threaded on the body, to be used only with a complete cable clamp.

** can only be used with a complete cable clamp (to be purchased separately)

dimensions in mm

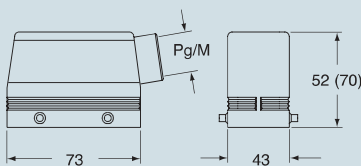
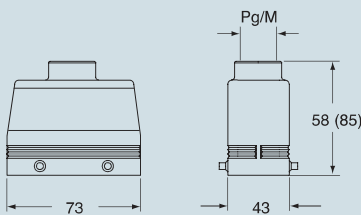
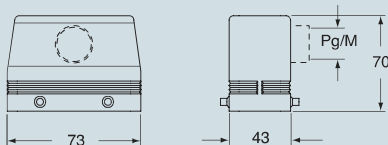
CHO (CAO) and MHO (MAO)**CHV (CAV) and MHV (MAV)****CAF/CFF and MAF/MFF**

dimensions in mm

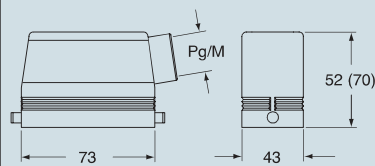
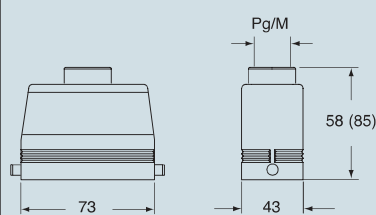
CHO L (CAO L) and MHO L (MAO L)**CHV L (CAV L) and MHV L (MAV L)**

CAV[®]US Type 4/4X/12

dimensions indicated are not binding
and may be changed without notice



inserts:		page
CDD	42 poles + ⊕	55
CQE	18 poles + ⊕	75
CN	10 poles + ⊕	81
CCE	10 poles + ⊕	88
CNE, CSE.....	10 poles + ⊕	89
CSS	10 poles + ⊕	100
CMSE	3+2 (aux) poles + ⊕	114
CMCE	3+2 (aux) poles + ⊕	114
CX	8/24 poles + ⊕	129
MIXO	3 modules	137÷151

insert centre distance:
57 x 27 mm

hoods
with 2 levers



hoods
with single lever



description	part No.	entry Pg	part No.	entry M	part No.	entry Pg	part No.	entry M
with levers and gasket, top entry	CHV 10 G	16	MHV 10 G25	25	CHV 10 LG	16	MHV 10 LG25	25
with levers and gasket, top entry, high construction	CAV 10 G	21	MAV 10 G25	25	CAV 10 LG21	21	MAV 10 LG25	25
with levers and gasket, top entry, high construction	CAV 10 G29	29	MAV 10 G32	32	CAV 10 LG29	29	MAV 10 LG32	32
with levers and gasket, top entry, high constr., without adaptor *	CFV 10 G	21	MFV 10 G25	25	CFV 10 LG21	21	MFV 10 LG25	25
with levers and gasket, top entry, high constr., without adaptor *	CFV 10 G29	29	MFV 10 G32	32	CFV 10 LG29	29	MFV 10 LG32	32

* enclosure without adaptor, threaded on the body, to be used only with a complete cable clamp.

dimensions in mm

CHV G (CAV G) and [CFV G],
MHV G (MAV G) and [MFV G]

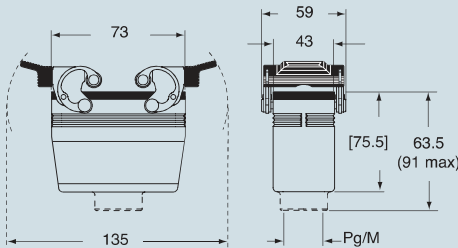

dimensions in mm

CHV LG (CAV LG) and [CFV LG],
MHV LG (MAV LG) and [MFV LG]

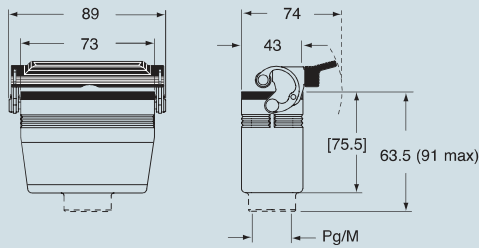

inserts:		page
CDD	42 poles + ⊕	55
CQE	18 poles + ⊕	75
CN	10 poles + ⊕	81
CCE	10 poles + ⊕	88
CNE, CSE	10 poles + ⊕	89
CSS	10 poles + ⊕	100
CMSE	3+2 (aux) poles + ⊕	114
CMCE	3+2 (aux) poles + ⊕	114
CX	8/24 poles + ⊕	129
MIXO	3 modules	137÷151

insert centre distance: **57 x 27 mm**

The covers for C, G and LG versions cannot be used together with coding pins. If this application is required, please contact ILME SpA.

hoods with 2 levers



covers

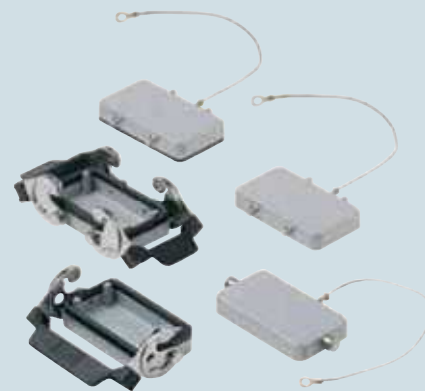

description	part No.	entry Pg	part No.	entry M	part No.
with levers, side entry ¹⁾	CHO 10 X	16	MHO 10 X20	20	
with levers, side entry ¹⁾			MHO 10 X25	25	
with levers, side entry, high construction ¹⁾	CAO 10 X	21	MAO 10 X32	32	
with levers, side entry, high construction ¹⁾	CAO 10 X29	29	MAO 10 X40	40	
with levers, top entry ¹⁾	CHV 10 X	16	MHV 10 X20 **	20	
with levers, top entry ¹⁾			MHV 10 X25	25	
with levers, top entry, high construction ¹⁾	CAV 10 X	21	MAV 10 X32	32	
with levers, top entry, high construction ¹⁾	CAV 10 X29	29	MAV 10 X40	40	
with 4 pegs (for housings with 2 levers and gasket) with 4 pegs and gasket (for housings with 2 levers) ²⁾ with 2 pegs (for housings with 1 lever and gasket)					CHC 10 CHC 10 C CHC 10 L
with 2 levers (for hoods with 4 pegs) with 1 lever (for hoods with 2 pegs)					CHC 10 G CHC 10 LG

¹⁾ May be combined with hoods:

- CHI/CHP/CAP 10 CS/CP/C
- MHP/MAP 10 CS/CP

²⁾ May be combined with hoods:

- CHO/CAO 10 X and CHV/CAV 10 X
- MHO/MAO 10 X and MHV/MAV 10 X

** can only be used with a complete cable clamp (to be purchased separately)

dimensions in mm

CHO X (CAO X) and MHO X (MAO X)

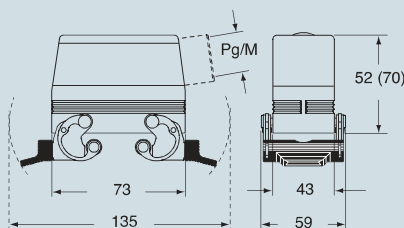

CHV X (CAV X) and MHV X (MAV X)

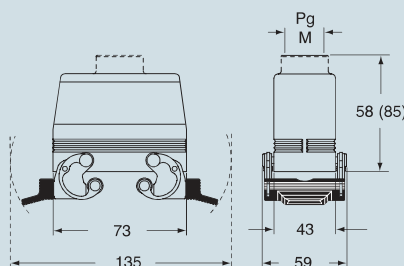

dimensions in mm

CHC



CHC C



CHC L

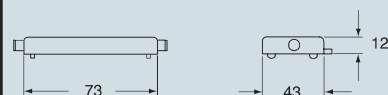

CHC G

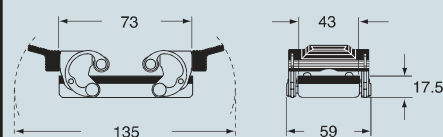

CHC LG

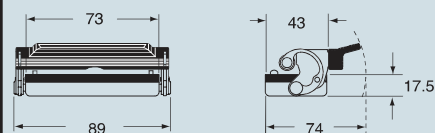

ILME® Type
4/4X/12

dimensions indicated are not binding
and may be changed without notice