

enclosures: size "104.62"

standard page: 232
 for 180 °C page: 233
 aggressive environments page: 234

- features according to EN 61984:
- 16A 500V 6kV 3**
- UL, CSA, CCC, GL certified
- for maximum current load, see the insert load curve section on page 31

**inserts,
screw terminal connections**

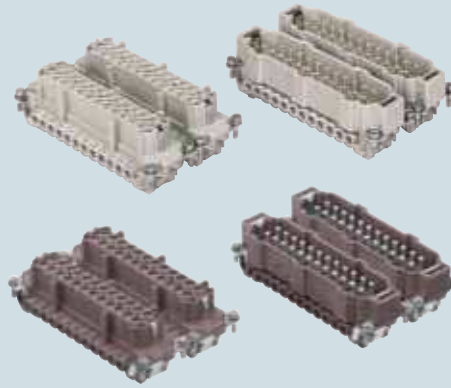

**inserts,
spring terminal connections**

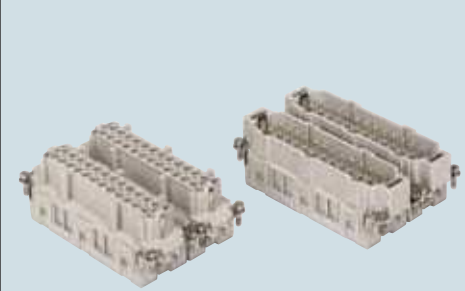

description	part No.	part No.	part No.	part No.
indirect, with plate 1) female inserts, No. (1÷24) and (25÷48) male inserts, No. (1÷24) and (25÷48)	CNEF 24 T CNEM 24 T	CNEF 24 TN CNEM 24 TN		
direct, without plate 2) female inserts, No. (1÷24) and (25÷48) male inserts, No. (1÷24) and (25÷48)	CNEF 24 TX CNEM 24 TX	CNEF 24 TXN CNEM 24 TXN		
indirect, with plate 1), use in temperatures up to 180 °C female inserts, No.(1÷24) and (25÷48), brown male inserts, No. (1÷24) and (25÷48), brown	CNEF 24 RYT * CNEM 24 RYT *	CNEF 24 RYTN * CNEM 24 RYTN *		
spring terminal female inserts, No. (1÷24) and (25÷48) male inserts, No. (1÷24) and (25÷48)			CSEF 24 CSEM 24	CSEF 24 N CSEM 24 N

- 1) for non-prepared conductors
 2) for bush terminal conductors

* CNE...RY version without plastic wire insertion guide cover available on request.

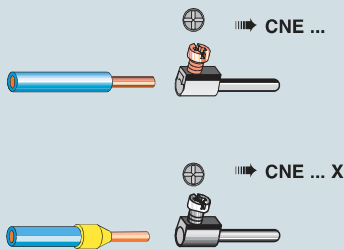

dimensions in mm

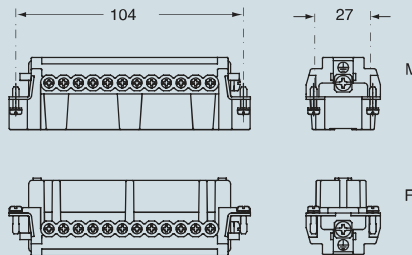

contacts side (front view)

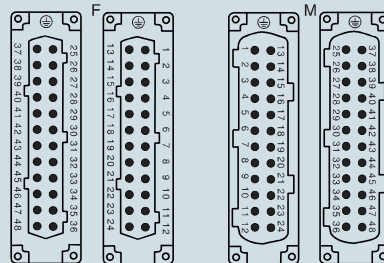

dimensions in mm

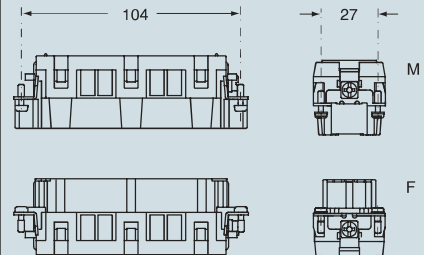

contacts side (front view)

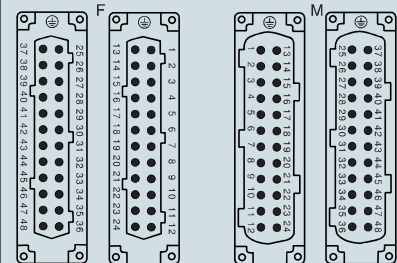

connection with spring terminal

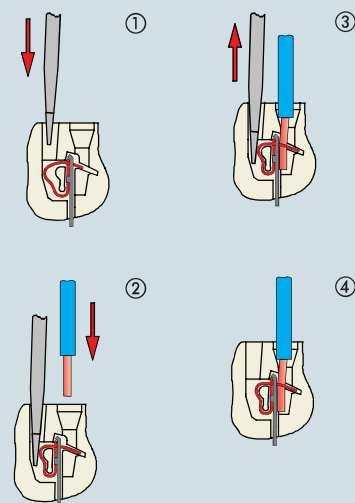

dimensions indicated are not binding and may be changed without notice

- inserts with plate, for section conductors: 0.5 ÷ 2.5 mm² - AWG 20 ÷ 14
- inserts without plate, for section conductors: 0.25 ÷ 2.5 mm² - AWG 24 ÷ 14
- torsion couple recommended for conductor fastening screws and stripping length see section feature of inserts on page 13

- inserts for section conductors: 0.14 ÷ 2.5 mm² - AWG 26 ÷ 14
- stripping length see section feature of inserts on page 13